

# INSTALLATION AND SERVICE MANUAL

**LIGMAN**  
NORTH AMERICA

For Installation of Odessa 13,14 Fixed-base, projectors.  
Model. UOD-50151,UOD-50152,UOD-50153,UOD-50154,UOD-50161,UOD-50163.

## Product drawing (dimensions)

CE IP65 IK08 CLASS I 0.3m

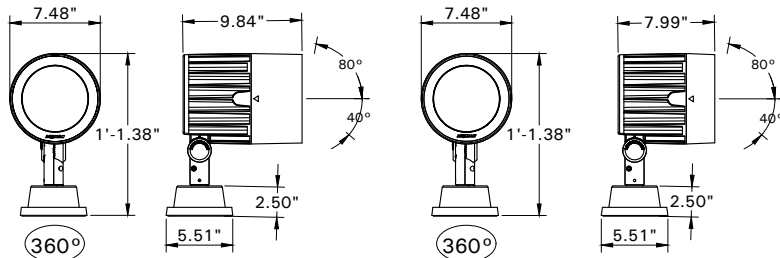

UOD-50151,UOD-50152  
UOD-50153,UOD-50154

UOD-50161,UOD-50163

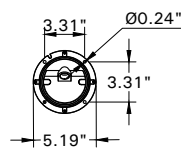

MOUNTING DETAIL  
MAX. MOUNTING HEIGHT 7M.

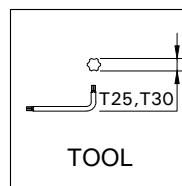

TOOL

1

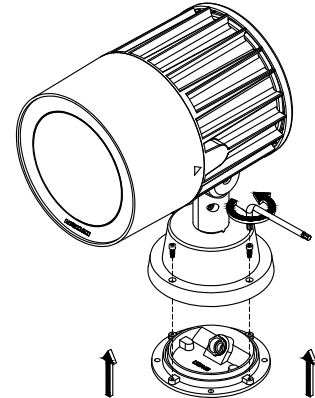

2

Torque : 3.0Nm.

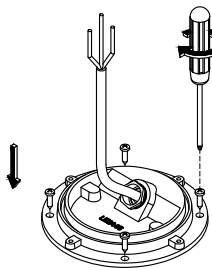

SCREW : M5  
SUPPLY

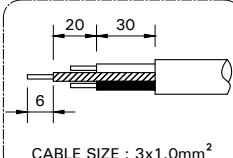

CABLE SIZE : 3x1.0mm<sup>2</sup>

3

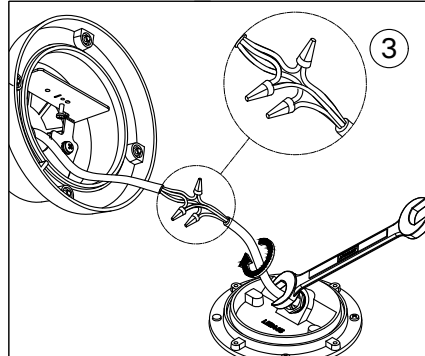

Torque : 4.2Nm.

4

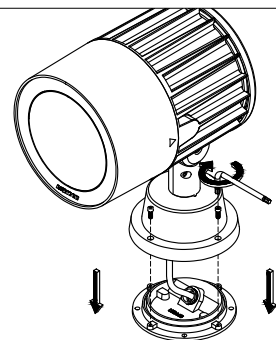

Torque : 2.0Nm.

5

ADJUST

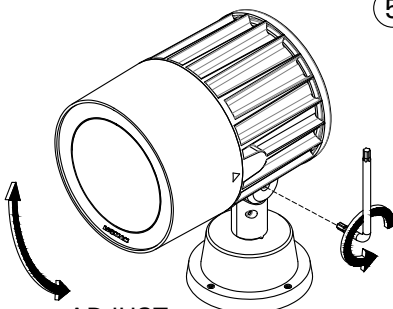

6

Torque : 4.3Nm.

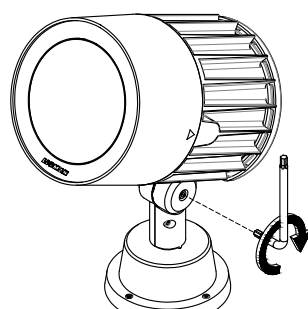

7

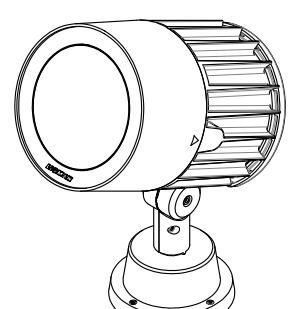

## Notice to Installer

### Wiring Instruction ⚠ Warning:

- Risk of Fire and Electrical Shock, This fixture must be installed only by a qualified electrician, Installation must adhere to the National Electrical Code (NEC) and all applicable local and federal regulations.
- Always disconnect power before servicing the fixture.

**Ligman Lighting USA**

7144 NE Progress Court, Hillsboro  
Oregon, 97124, USA  
Tel : 503 645 0500 | Fax : 503 645 8100